

Completed Autumn 1850, with initial accommodation for 539 paupers.

West Beckham
Approx 1880

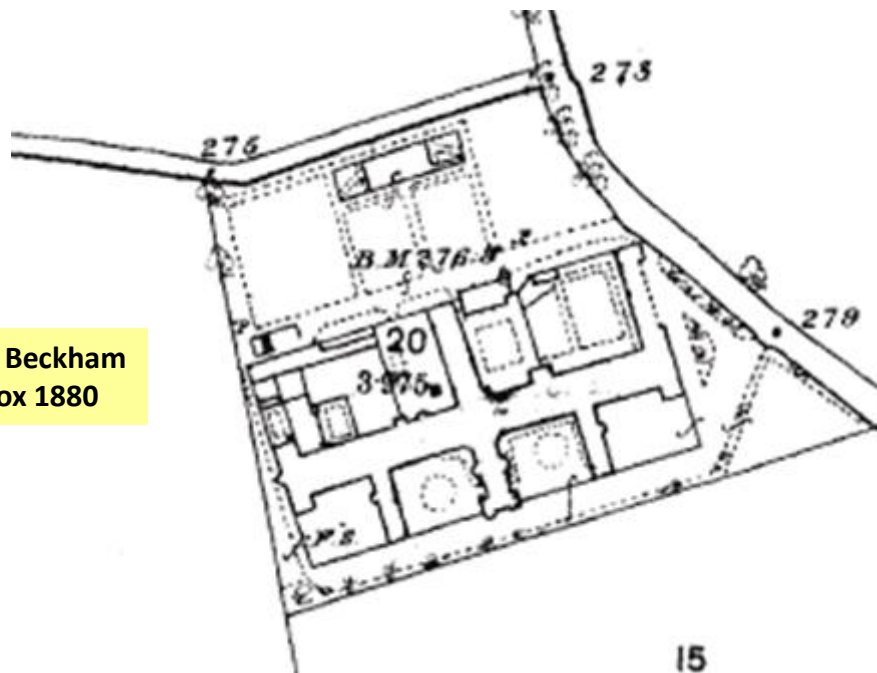

Closed in Autumn 1850 when the paupers were transferred to West Beckham.

Gimingham
Approx 1880

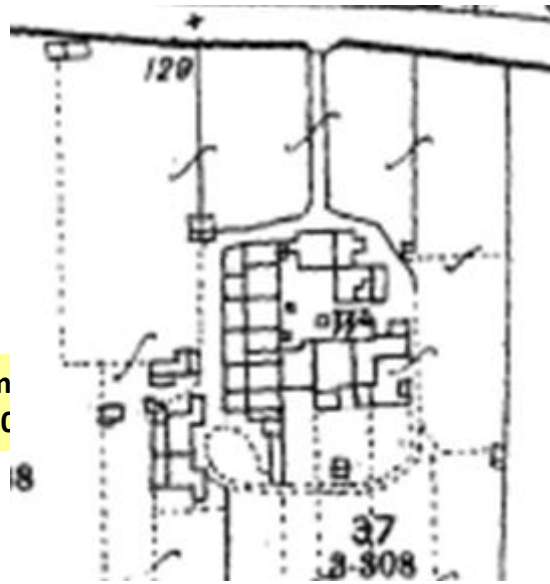

Approx 1840

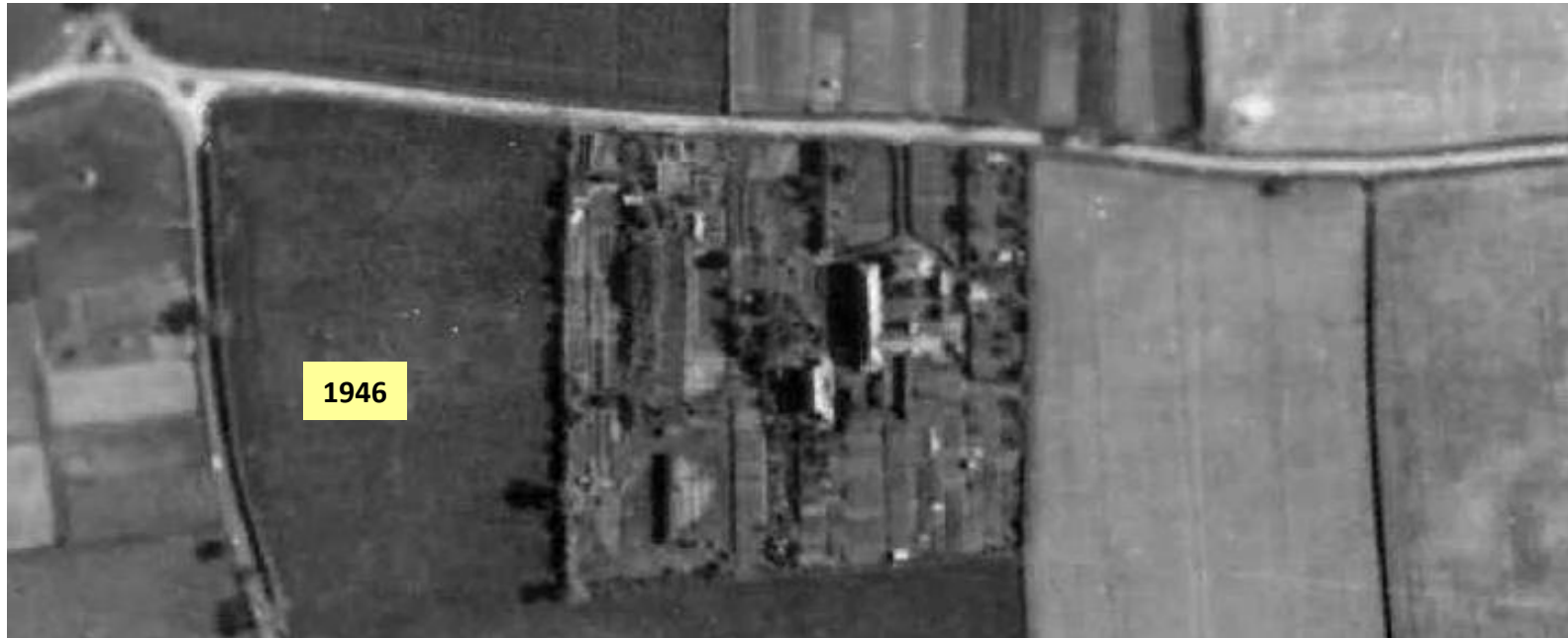
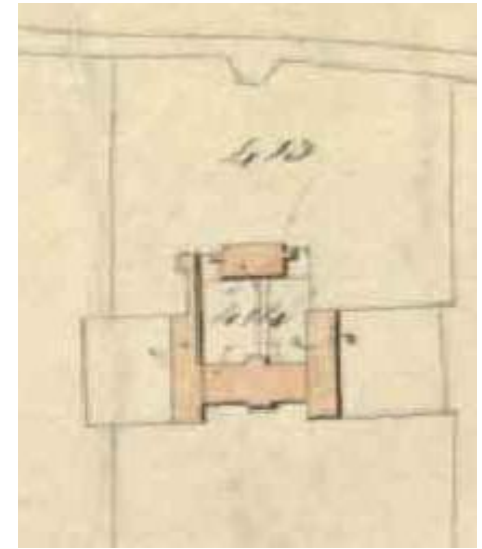

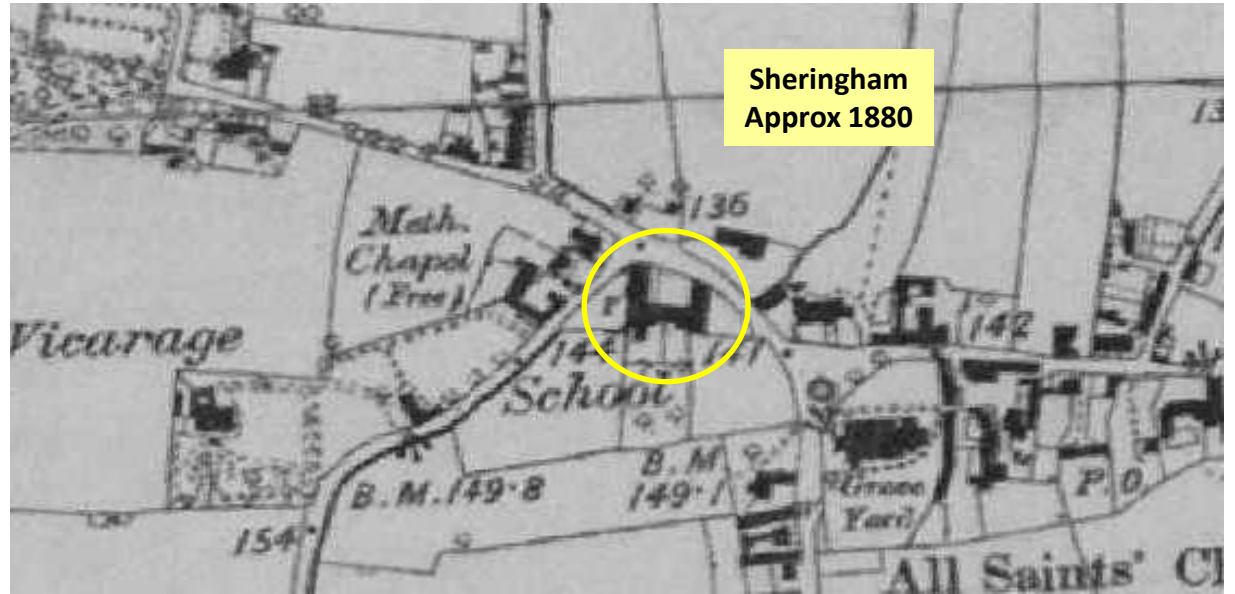

“The Visiting Committee of the Sheringham Workhouse recommended that large folding doors should be made for the entrance to the Workhouse so as to admit a horse & cart, as the Tradespeople were obliged to unload there <sic> goods in the Street, which subject them to inconvenience.” - Minutes of the Erpingham Poor Law Board dated 22 December 1845

“Resolved That the Tender of Mr. J. Darken of Holt to provide and fix larger doors and other alterations at the Sheringham Workhouse for the Sum of £12..10..0 be accepted by this Board.” – Minutes of the Erpingham Poor Law Board dated 29 December 1845

